

Blind Flange, IPS Carbon Steel
ANSI B16.5, B16.47 and AWWA C207

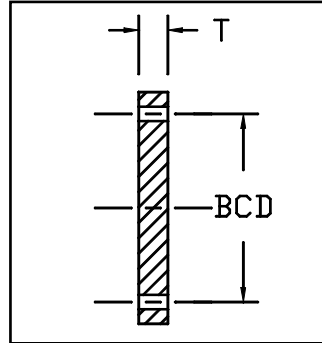

Dimensions and weights are approximate and subject to change. Please call for sizes not listed.

IPS Pipe Size	Nominal OD (in)	Pressure Class (psi)	Dimension (in)		Weight (Lbs)	Bolt	
			BCD	T		Diameter	Number
2"	2.375*	250	4 3/4	5/8	5	5/8	4
3"	3.500*	250	6	5/8	8	5/8	4
4"	4.500*	250	7 1/2	5/8	12	5/8	8
6"	6.625*	250	9 1/2	11/16	18	3/4	8
8"	8.625*	250	11 3/4	11/16	27	3/4	8
10"	10.750*	200	14 1/4	11/16	38	7/8	12
12"	12.750*	200	17	13/16	63	7/8	12
14"	14.000*	200	18 3/4	15/16	89	1	12
16"	16.000*	160	21 1/4	1	119	1	16
18"	18.000*	160	22 3/4	1 1/16	141	1 1/8	16
20"	20.000*	160	25	1 1/8	182	1 1/8	20
22"	22.000*	160	27 1/4	1 3/16	213	1 1/4	20
24"	24.000*	160	29 1/2	1 1/4	275	1 1/4	20
28"	28.000*	120	34	1 5/16	370	1 1/4	28
30"	30.000*	120	36	1 3/8	444	1 1/4	28
32"	32.000*	120	38 1/2	1 1/2	588	1 1/2	28
36"	36.000*	120	42 3/4	1 5/8	735	1 1/2	32
42"	42.000*	100	49 1/2	1 3/4	1,085	1 1/2	36
48"	48.000*	80	56	1 3/4	1,369	1 1/2	44

* Meets AWWA

San Francisco	511 Tunnel Avenue, Brisbane, CA 94005	415-467-4630	FAX 415-467-1010
Los Angeles	1304 E. San Bernardino Ave., San Bernardino, CA 92408	909-799-7800	FAX 909-799-5558
Bakersfield	5221 Gilmore Ave., Bakersfield, CA 93308	661-326-7800	FAX 661-326-7805
Reno	675-B Edison Way, Reno, NV 89502	775-856-1888	FAX 775-856-1844