

# P&F Distributors

HDPE Pipe IS OUR BUSINESS - Proudly  
Servicing California for over 50 Years



## Piping Solution for Agriculture, Irrigation and Quick Connect Applications

### Lowest Total Cost of Ownership

Lowest life cycle cost of any piping material when accounting for all costs: direct, indirect and operational costs

### Installation Flexibility – So Many Choices

Durable, lightweight and flexible paves way for installation methods whether above, below grade or around obstacles

### Long Continuous Length

Pipe lengths are available as 40-50 ft joints to reels spanning several thousand feet – When needing vast and customizable approach, Onsite extrusion technology is available as appropriate

### 50+ Year Rated – Same Pipe New and Old

Rigorous material strength and durability testing provides lifetime material performance

### Quick Installation

The quick connect and disconnect HDPE fitting can be joined effortlessly and efficiently thus eliminating heat fusion between pipe lengths

### Seismic Resistant Pipe

HDPE materials's elasticity and durability provides a critical lifeline and complete piping solution to seismically active regions

Please Contact for Additional Technical Information or Tailored Presentation

**NORTHERN CALIFORNIA**  
511 Tunnel Avenue  
Brisbane, CA 94005  
415.467.4630  
PFDistributors.com

**NEVADA**  
675-B Edison Way  
Reno, NV 89502  
775.856.1888

**SOUTHERN CALIFORNIA**  
1304 E. San Bernardino Ave  
San Bernardino, CA 92408  
909.799.7800

**CENTRAL CALIFORNIA**  
4039-C Well Tech Way  
Bakersfield, CA 93308  
661.589.7300

HDPE - IPS Sizing		DR 11			DR 17		
Pressure Class		200 psi			125 psi		
Pipe Size	Actual OD	Min. Wall	Avg. ID	Weight	Min. Wall	Avg. ID	Weight
in.	in.	in.	in.	lb/ft	in.	in.	lb/ft
2	2.375	0.216	1.917	0.64	0.140	2.079	0.43
3	3.50	0.318	2.825	1.39	0.206	3.064	0.94
4	4.50	0.409	3.633	2.31	0.265	3.939	1.55
6	6.625	0.602	5.348	5.00	0.390	5.799	3.36
8	8.625	0.784	6.963	8.47	0.507	7.549	5.69
10	10.75	0.977	8.678	13.16	0.632	9.409	8.83
12	12.75	1.159	10.293	18.51	0.750	11.160	12.43

Pipe sizing per ASTM F714. Pressure Class is Water at 73F. Average ID approximated. Weights based on PPI TR-7

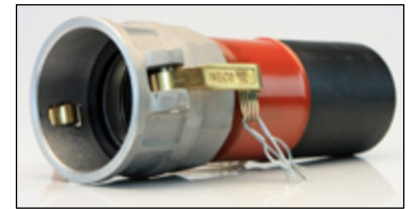

Male HDPE Lock Transition						
Size	A	B	C	D	E	F
in.	in.	in.	in.	in.	in.	in.
2	~1.640	1.917	2.375	~6.000	4	~10.000
3	~2.240	2.826	3.5	~6.500	4	~10.500
4	~3.230	3.633	4.5	~7.000	5	~12.000
6	~4.800	5.349	6.625	~8.000	7	~15.000

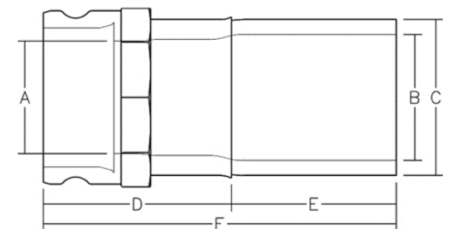

Female HDPE Lock Transition						
Size	A	B	C	D	E	F
in.	in.	in.	in.	in.	in.	in.
2	~1.640	1.917	2.375	~6.250	4	~10.250
3	~2.240	2.826	3.5	~7.125	4	~11.000
4	~3.230	3.633	4.5	~8.000	5	~13.000
6	~4.800	5.349	6.625	~9.000	7	~16.000

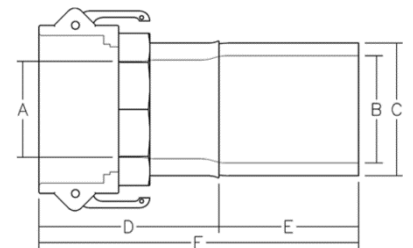

Quick Disconnect System										
Size	A	B	C	D	E	F	G	H	J	K
in.	in.	in.	in.	in.	in.	in.	in.	in.	in.	in.
3	3.5	2.83	~2.45	4.71	5.4	4	7.55	5.75	11.55	9.75
4	4.5	3.63	~3.23	5.7	6.56	4	8.15	6.25	12.15	10.25
6	6.63	5.35	~4.92	7.06	8.38	6	10	8.05	16	14.05
8	8.63	6.96	~6.16	9.04	10.53	8	11.15	9.25	19.15	17.25
10	10.75	8.68	~7.69	11.85	13.35	10	14.75	12.25	24.75	22.25
12	12.75	10.29	~9.74	14.38	16.5	12	17	14	29	26

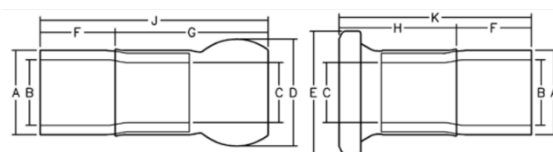

Pipe, Fittings and Fusion Equipment is available from stock locally!  
Fusion Training Available Locally - Easily Learned, Retained and Duplicated

Please Contact for Additional Technical Information or Tailored Presentation

**NORTHERN CALIFORNIA**  
511 Tunnel Avenue  
Brisbane, CA 94005  
415.467.4630  
PFDistributors.com

**NEVADA**  
675-B Edison Way  
Reno, NV 89502  
775.856.1888

**SOUTHERN CALIFORNIA**  
1304 E. San Bernardino Ave  
San Bernardino, CA 92408  
909.799.7800

**CENTRAL CALIFORNIA**  
4039-C Well Tech Way  
Bakersfield, CA 93308  
661.589.7300